

# COLEMAN EQUIPMENT, INC.

# Manipulator™

## Manipulator™

**Coleman Pneumatic Manipulator** is a balancing arm designed for applications requiring a stable attachment platform, or the need to reach in or under an obstacle. With Auto-weight sensing, an operator can lift a load into balance, making the load “weightless”. The operator then simply pushes on the load to move it through the manipulator's full work envelope. It is this feature which allows the operator to use both hands to smoothly and accurately place heavy and cumbersome items. Coleman designs and manufactures custom gripping devices and pneumatic circuits for your specific requirements.



### For Performance and Quality

- Heavy duty construction for long life
- Wide variety of standard sizes and capacities
- 360 degree continuous rotation and air union on main pivot
- Automatic Weight Sensing and Balancing control circuit available
- 100% pneumatic control circuits run on oil free air (no lubricator to refill or oil mist in the exhaust)
- Lower controls can be disconnected and mounted on an attachment
- 100% Duty Cycle
- Double Link Arm allows for rigid or cantilevered connections to attachments
- Floor, ceiling, and trolley mounted configurations are available
- Coleman Speed Valve and safety circuits prevent erratic movements and control the manipulator if the air supply is lost

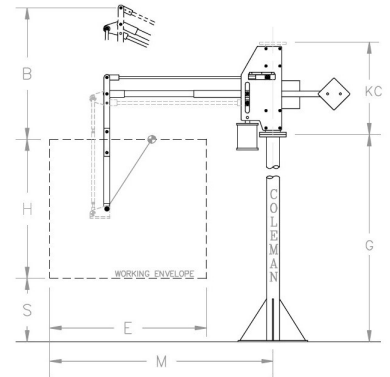

### Specifications for Standard Models

Model	Capacity		Dimensions						
	SLA	DLA	B	E	G	H	KC	M	S
PM 75	165 lbs.	148 lbs.	57"	67"	63"	60"	52"	88"	12"
PM 150	330 lbs.	297 lbs.	57"	67"	63"	60"	52"	88"	12"
PM 250	550 lbs.	495 lbs.	58"	66"	62"	60"	57"	88"	12"
PM 375	825 lbs.	742 lbs.	58"	66"	62"	60"	57"	88"	12"
PM 500	1100 lbs.	990 lbs.	75"	80"	70"	69"	56"	113"	12"
PM 100	2200 lbs.	1980 lbs.	75"	80"	70"	69"	56"	113"	12"

Approximate dimensions in inches and capacities in pounds for standard arm ratio units supplied with air at 90 psi.

Longer and shorter arms available.

